

MLPE MOUNT

For microinverters and power optimizers, compatible with all module frame heights

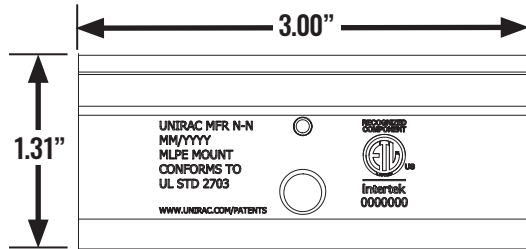

TECHNICAL DATA



PART NUMBER	DESCRIPTION	RECOMMENDED TORQUE (FT-LBS)	TOOL
008114M	MLPE MOUNT ASSEMBLY	20	1/4" Allen Wrench
MLPEMNT-US	UNIVERSAL MLPE MOUNT	20	1/2" Socket

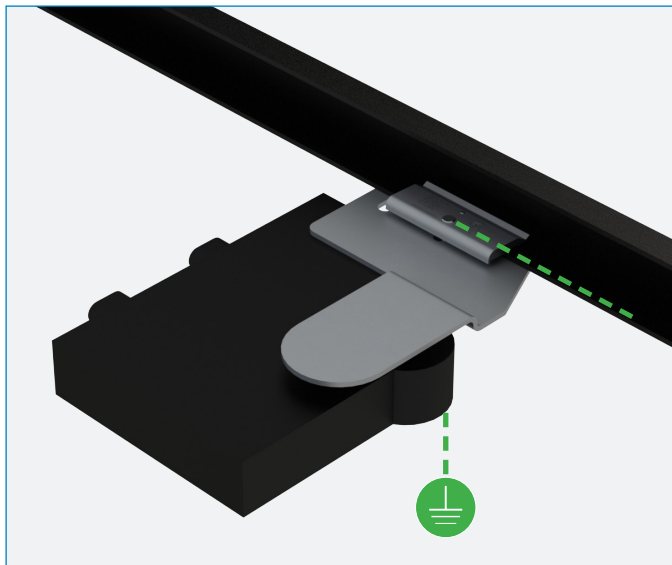
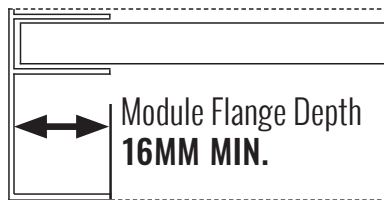

The MLPE Mount's bolt and bonding pin establish bonding between MLPE Mount and module. It is Single Use only.

FEATURES

- COMPATIBLE WITH ALL PV RACKING SYSTEMS
- Allows single tool (1/2" Socket) installation with NXT, SM, and RM10 EVO

MAINTENANCE NOTES

Conduct periodic inspections for loose components, loose fasteners or any corrosion, immediately replace any affected components.

INSTALLATION STEPS

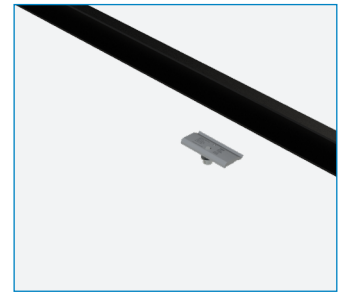

POSITION MLPE MOUNT PARALLEL TO MODULE FRAME

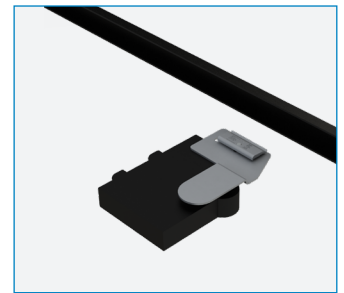
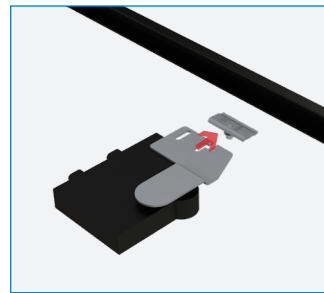

SLIDE MOUNT ONTO MLPE

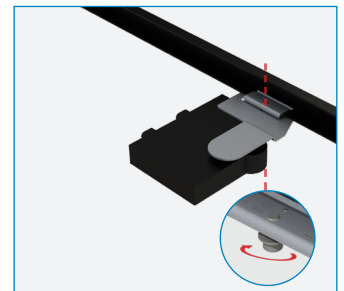
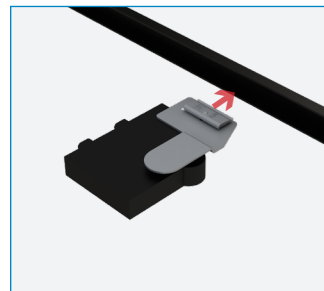

ENGAGE MLPE & MOUNT ONTO MODULE FRAME FLANGE AND TIGHTEN
Required Torque - 20ft-lbs

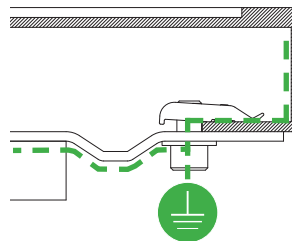

INSTALLED CROSS SECTION

TIP: Use module frame wire clips during system installation to manage MLPE cables.

UL2703
RECOGNIZED

- For use with Microinverters and Power Optimizers
- Compatible with All Module Frame Heights

MLPE MOUNT

For microinverters and power optimizers, compatible with all module frame heights



COMPATIBLE MODULE LIST

Electrical Bonding and Grounding Test Modules

The list below is not exhaustive of compliant modules but shows those that have been evaluated and found to be electrically compatible with the MLPE MOUNT system.

MANUFACTURER	MODULE MODEL / SERIES
Aleo	P18/P19/S18/S19/S59/S79.
AU Optronics	PM Series
Auxin	AXN6M610Txxx, AXN6P610Txxx, AXN6M612Txxx, AXN6P612Txxx.
Axitec	AXIblackpremium 60 (35mm), AXIpower 60 (35mm), AXIpower 72 (40mm), AXIpremium 60 (35mm), AXIpremium 72 (40mm).
Boviet	BVM6610, BVM6612, BNM6612
BYD	P6K Series (35mm), MHK-36
Canadian Solar	CS6V-xxxM, CS6P-xxxP, CS6K-xxxM, CS6K-xxxMSCS6U-P, CS6U-M, CS6X-P, CS6K-MS, CS6K-M, CS6K-P, CS6P-P, CS6P-M, CS3U-P, CS3U-MS, CS3K-P, CS3K-MS, CS1K-MS, CS3K, CS3K, CS3U, CS3U-MB-AG, CS3K-MB-AG, CS3K-MB-AG, CS6K, CS6U, CS3L and CS3W.
Centrosolar America	C-Series, E-Series.
Certainteed	CTxxxMxx-01, CTxxxPxx-01, CTxxxMxx-02 Where "xx" denotes frame and backsheet color.
Eco Solargy	ORION 1000 ECOXXXH156P-60, APOLLO 1000 ECOXXXT156M-60, and APOLLO 1000 ECOXXXA156M-60.
ET Solar	ETAC Module, ET Module
Freedom Forever	FF-MP-BBB 370
GCL	40mm frame: GCL-P6/72. 35mm frame: GCL-P6/72, GCL-P6/72H, GCL-M6/72, GCL-M6/72H. 35mm frame (Black frame): GCL-P6/60, GCL-M6/60.
Hansol	TD-AN3 (40mm), TD-AN4, UB-AN1 (35mm), UD-AN1 (40mm).
Heliene	36M, 60M, 72M, 60P, and 72P. HSPE 144HC M6 Mono & Bifacial
Hyundai	KG, MG, TG, RI, RG, TI, MI and KI series (35mm and 40mm).
Hanwha SolarOne	HSL 60, HSL 72.
Hanwha Q-Cells	G3, L-G4 and L-G2, Q.PLUS G4 xxx, Q.PLUS BFR G4.1/TAA xxx, Q.PLUS BFR, G4.1/MAX xxx, Q.PLUS BFR G4.1 xxx, Q.PRO-G4 xxx, Q.PRO EC-G4.4 xxx, Q.PRO BFR G4 xxx, Q.PRO BFR G4.1 xxx, Q.PRO BFR G4.3 xxx, Q.PEAK-G4.1 xxx Q.PEAK- G4.1/MAX xxx, Q.PEAK BLK G4.1 xxx, Q.PEAK-G4.1/TAA xxx Q.PEAK BLK G4.1/TAA xxx, B.LINE PRO BFR G4.1 xxx, B.LINE PLUS BFR G4.1 xxx, B.LINE PRO BFR G4.1 xxx, Q.PEAK DUO-G5-xxx, Q.PEAK DUO-G5.X-xxx and Q.PEAK DUO BLK-G5-xxx, Q.PEAK L G4.2, Q.PLUS L G4.2, Q.PLUS L G4.1 -35mm, Q.PLUS L G4 - 35mm, Q.PRO L G4 -35mm, Q.PRO L G4.1 - 35mm, Q.PRO L G4.2 - 35mm, B.LINE PLUS L G4.2 - 35mm, B.LINE PRO L G4.1 - 35mm, B.LINE PRO L G4.2 - 35mm, Q.PLUS L-G4.2/TAA -35mm, Q.PEAK DUO L-G5.2, Q.PEAK DUO L-G5.3 (380-395), Q.Peak Duo L-G6 xxx, Q.Peak Duo L-G6.2 xxx, Q.Peak Duo L-G6.3 xxx, Q.Peak Duo G6 xxx, Q.Peak Duo BLK-G6 xxx.

- Unless otherwise noted, all modules listed above include all wattages and specific models within that series. Variable wattages are represented as "xxx"
- Items in parenthesis are those that may or may not be present in a compatible module's model ID
- Slashes "/" between one or more items indicates that either of those items may be the one that is present in a module's model ID
- Please see the MLPE MOUNT UL2703 Construction Data Report at unirac.com to ensure the exact solar module selected is approved for use with MLPE MOUNT attachment.

MLPE MOUNT

For microinverters and power optimizers, compatible with all module frame heights



COMPATIBLE MODULE LIST

Electrical Bonding and Grounding Test Modules

The list below is not exhaustive of compliant modules but shows those that have been evaluated and found to be electrically compatible with the MLPE MOUNT system.

MANUFACTURER	MODULE MODEL / SERIES
HT Solar	HT60-156(M) (NDV) (-F), HT 72-156(M/P).
ITEK	iT-xxx, iT-xxx-HE, iT-xxx-SE, iT-xxx-SE-72 (40mm).
JA Solar	JAP6 60-xxx, JAM6-60-xxx/SI, JAM6(K)-60/xxx, JAP6(k)-72-xxx/4BB, JAP72SY-xxx/ZZ, JAP6(k)-60-xxx/4BB, JAP60SY-xxx/ZZ, JAM6(k)-72-xxx/ZZ, JAM72SY-xxx/ZZ, JAM6(k)-60-xxx/ZZ, JAM60SY-xxx/ZZ, JAM 72S09 i. YY: 01 white backsheet, 02 black backsheet, 03 half-cell and white backsheet, 09 M4 cell, 10 M4 1/2 cell ii. ZZ: SC standard cell, PR = perc, BP = bifacial, HiT = HIT, IB = IBC, MW = MWT
Japan Solar	JPS-xxxP-60 (35mm), JPS-xxxM-60 (35mm), JPS-xxx-P-72 (40mm), JPS-xxxM-60-BB (35mm), JPS-xxx-P-72-BB (40mm).
Jinko	JKM xxx P-60, JKM xxx PP-60, JKM xxx M-60, JKM xxx M-60B, JKMS xxx PP-60 JKMS xxx P-60, JKMSxxx-72, JK-MxxxP-72, JKMSxxxP-72, JKMxxxM-72, JK07A (JKMSxxxPP-60 & JKMSxxxPP-72), JK07B (JKMSxxxPP-60), JKM xxx PP-60(Plus), JKM xxx PP-60B, JKM xxx M-60B, JKMSxxxM-60, JKMSxxxM-60-EP, JKM xxx P-72B, JKMxxxPP-72, JK-MxxxPP-72B, JKMxxxPP-72(Plus), JKMSxxxPP-72, JKMxxxM-72-V, JKMxxxPP-72-V, JKMxxx-72L-V, JKMxxx-72HL-V, JKMxxxM-60L, JKMxxxM-60BL, JKMxxxM-60HL, JKMxxxM-72HL-V, JKMxxxM-72L-V.
Kyocera	KD-F Series, KU26x-6MCA where x is 0 or 5.
LG	MONO X, MONO X 2, Mono X Plus, Mono Neon 2, Mono Neon 2 LG xxx S1C-L4, LG xxx N1C-G4 LG xxx S1C-A5, LG xxx N1C-A5, LGxxxQ1C(Q1K)-A5, LGxxxN1C(N1K)-A5, LGxxxS1C-A5, LGxxxA1C-A5, LGxxxN2T-A4, LGxxxN2T-A5, LGxxxN2W-A5 LGxxxS2W-A5, LGxxxE1C-A5, LGxxxN1C(N1K)-G4, LGxxxN2W-G4, LGxxxS2W-G4 LGxxxS1C-G4, LGxxxE1K-A5.
LONGi	40mm LR6-60, LR6-72, LR6-60 HV, LR6-72 HV, LR6-60 PH, LR6-72 PH, LR6-60 PE 45mm LR6-72 PE 40mm Black frame LR6-60 BK LR6-72 BK, LR6-60 PB 45mm Black frame LR6-72 PB
Mission Solar	MSE series
Mitsubishi	MJE, MLE
NSP	D6M and D6P

- Unless otherwise noted, all modules listed above include all wattages and specific models within that series. Variable wattages are represented as “xxx”
- Items in parenthesis are those that may or may not be present in a compatible module’s model ID
- Slashes “/” between one or more items indicates that either of those items may be the one that is present in a module’s model ID
- Please see the MLPE MOUNT UL2703 Construction Data Report at unirac.com to ensure the exact solar module selected is approved for use with MLPE MOUNT attachment.

MLPE MOUNT

For microinverters and power optimizers, compatible with all module frame heights



COMPATIBLE MODULE LIST

Electrical Bonding and Grounding Test Modules

The list below is not exhaustive of compliant modules but shows those that have been evaluated and found to be electrically compatible with the MLPE MOUNT system.

MANUFACTURER	MODULE MODEL / SERIES
Panasonic	VBHNxxxSA16/VBHNxxxSA16B, VBHNxxxSA15/VBHNxxxSA15B, VBHNxxxKA01, VBHN SA17/18/KA03/04, VBHNxxxSA17G, VBHNxxxSA17E/18E. EVPV xxx, EVPV xxxH, EVPV xxxK, EVPV xxx PK
Peimar	SGxxxM (FB), SGxxxM (BF), SGxxxM
Phono Solar Technology	Diamond series
Risen	RSM72-6 (MDG) (M), RSM60-6
REC Solar	Eco PEAK Energy Series, PEAK Energy BLK2 Series, PEAK Energy 72 SeriesTWINPEAK 2 SERIES, TWINPEAK 2 BLK2 SERIES, TWINPEAK SERIES
Renesola	Virtus II with module ratings of 250-260 in increments of 5. 156 series with module ratings of 270-275.
S-Energy	SN3xxM-10/SN3xxP-10 (40mm), SNxxxM-10/SN2xxP-10 (40mm), SNxxxP-15 (40mm)
SEG	SEG-xxx-BMD-HV
Seraphim	SEG-6PA-XXXWB (XXX=280 to 335), SEG-6PA-XXXBB (XXX=280 to 335), SEG-6PB-XXXWW (XXX=240 to 275), SEG-6PB-XXXWB (XXX=240 to 275), SEG-6PB-XXXBB (XXX=240 to 275), SEG-6MA-XXXWW (XXX=290 to 370), SEG-6MA-XXXWB (XXX=290 to 370), SEG-6MA-XXXBB (XXX=290 to 370), SEG-6MB-XXXWW (XXX=250 to 305), SEG-6MB-XXXWB (XXX=250 to 305), SEG-6MB-XXXBB (XXX=250 to 305), SEG-E01A-XXX (XXX=325 to 400), SEG-E01B-XXX (XXX=275 to 330), SEG-E11A-XXX (XXX=325 to 385), SEG-E11B-XXX (XXX=275 to 320) SRP-XXX-6QA-WX-XX (XXX=345 to 370) (XX=40 or 50 mm) (X=B or S for Black or Silver frame), SRP-XXX-6QA-BX-XX (XXX=345 to 370) (XX=40 or 50 mm) (X=B or S for Black or Silver frame), SRP-XXX-6QB-WX-XX (XXX=280 to 300) (XX=40 or 50 mm) (X=B or S for Black or Silver frame), SRP-XXX-6QB-BX-XX (XXX=280 to 300) (XX=40 or 50 mm) (X=B or S for Black or Silver frame)
Sharp	ND-24CQCJ, ND-25CQCS, ND-Q235F4, ND-F4Q300 60 and 72 NUSA-xxx/NUSC-xxx
Silfab	SLA-M and SLG-M
SolarEver	SE-166_83-xxxM-120N
SolarWorld	Sunmodule Protect Sunmodule Plus
Solaria	PowerXT-xxxy-zz, PowerXT-xxxR-PD/BD, PowerXT-xxxR-AC, PowerXT-xxxC wherexx is power in watts y is module size (R for residential, C for commercial) zz is other PowerXT-xxxy-zz all share the same rail profiles

- Unless otherwise noted, all modules listed above include all wattages and specific models within that series. Variable wattages are represented as "xxx"
- Items in parenthesis are those that may or may not be present in a compatible module's model ID
- Slashes "/" between one or more items indicates that either of those items may be the one that is present in a module's model ID
- Please see the MLPE MOUNT UL2703 Construction Data Report at unirac.com to ensure the exact solar module selected is approved for use with MLPE MOUNT attachment.

MLPE MOUNT

For microinverters and power optimizers, compatible with all module frame heights



COMPATIBLE MODULE LIST

Electrical Bonding and Grounding Test Modules

The list below is not exhaustive of compliant modules but shows those that have been evaluated and found to be electrically compatible with the MLPE MOUNT system.

MANUFACTURER	MODULE MODEL / SERIES
Sonali	SS-M Bi Facial 144 Cell, SS-M-xxx Series
SunEdison/Flextronics	F-Series / FXS, R-Series / FXS
Suniva	MVX xxx-60-72, OPT xxx-60-4-100
Sun Edison	F-Series, R-Series
Sunpower	E20-xxx-COM, X21-xxx, X22-360-C-AC. **Evaluated with both the G3 and G5 frame** SPR-P17-xxx-COM A-Series A400-BLK, SPR-MAX3-XXX-R
Suntech	STP "XXX", STPXXXS-B60/Wnhb
Talesun	TP572, TP596, TP654, TP660 (35mm/40mm), TP672, Hipor M350+ (40mm), Talesun Smart (35mm) M = Mono, P = Poly, B = Black, T = Transparent (H) = 1500V, without (H) is 1000V
Tesla	TxxxH
Trina Solar	PA05, PD05, PD15, PE14 TSM-xxx PA05.08, TSM-xxx PD05.10, TSM-xxx PD05.08, TSM-xxx DD05.08TSM-xxx DD05A.05(II), TSM-xxx DD05A.05(II), TSM-DD14/PE14/PD14, TSM- DE14
Upsolar	UP-MxxxP, UP-MxxxP-B, UP-MxxxM, UP-MxxxM-B
Yingli	YL xxx P-29b, YLM 60, YLM 72, YGE/YLM, YL xxx P-35b, YL xxx D-30b, YL xxx D-36b
Waaree	AC, Adiya 60/72 Mono/Poly Black, Adiya 60/72 Multi
Winaico	WST (35mm), WSP (40mm)
Z Shine	ZXM6-NH144-166_2094

- Unless otherwise noted, all modules listed above include all wattages and specific models within that series. Variable wattages are represented as "xxx"
- Items in parenthesis are those that may or may not be present in a compatible module's model ID
- Slashes "/" between one or more items indicates that either of those items may be the one that is present in a module's model ID
- Please see the MLPE MOUNT UL2703 Construction Data Report at unirac.com to ensure the exact solar module selected is approved for use with MLPE MOUNT attachment.