

We support PV systems
Formerly Everest Solar Systems 

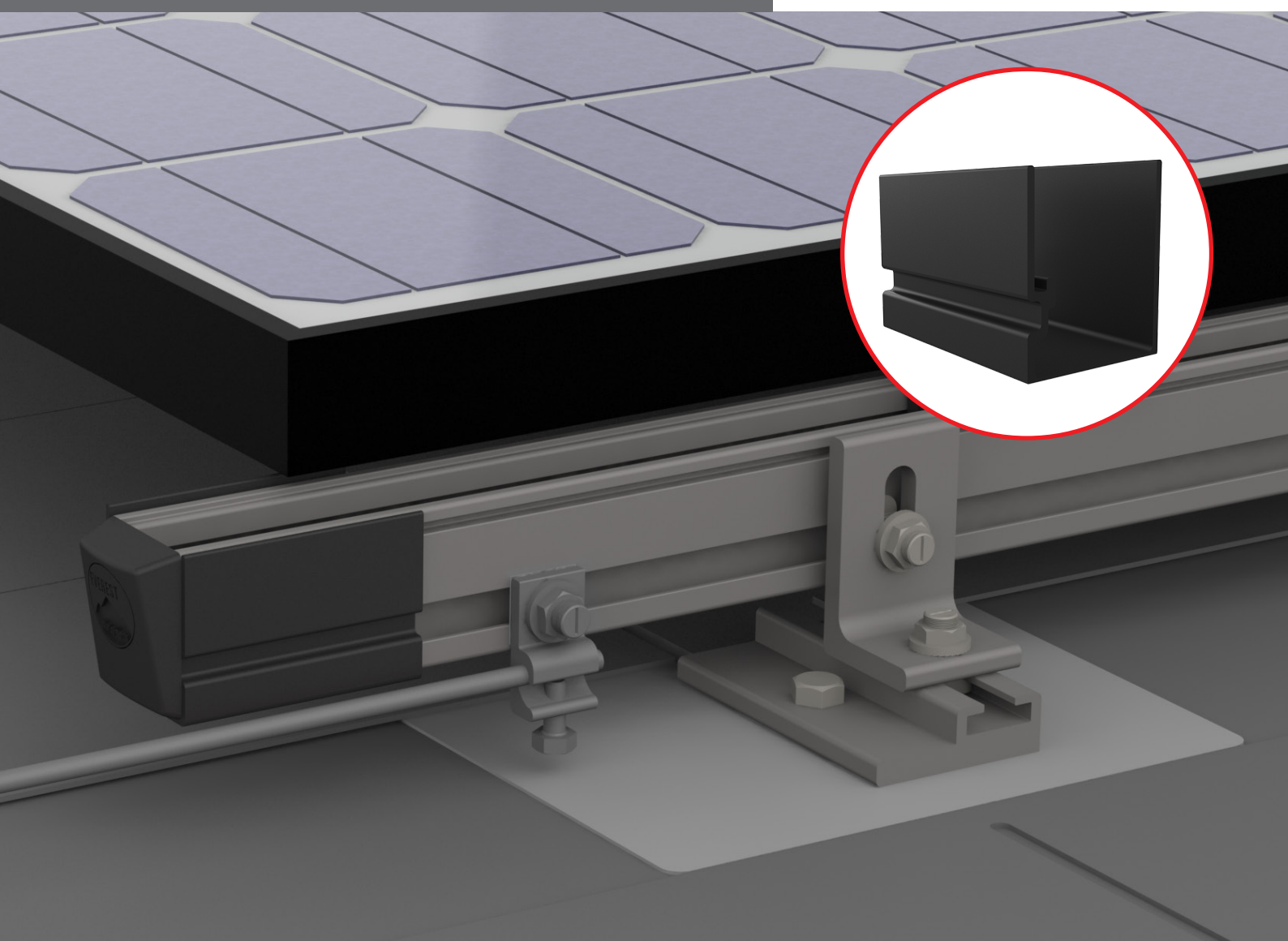

CrossRail Sleeve

QUICK GUIDE



Components



Part Number	Description
4000583	CrossRail 48-X/48-XL 3" Sleeve
4000177	Sleeve CR 44-X

Assembly

1



To snap the CrossRail Sleeve on CrossRail, first place the CrossRail Sleeve over the rail with the T-Bolt Key on the T-Bolt Channel.

Once the CrossRail Sleeve is in the correct position, place your hand over the top of the rail with fingers in the groove of the CrossRail Sleeve.

Slowly push in on the groove while pulling up. You should hear a snap indicating the CrossRail Sleeve has been attached fully.

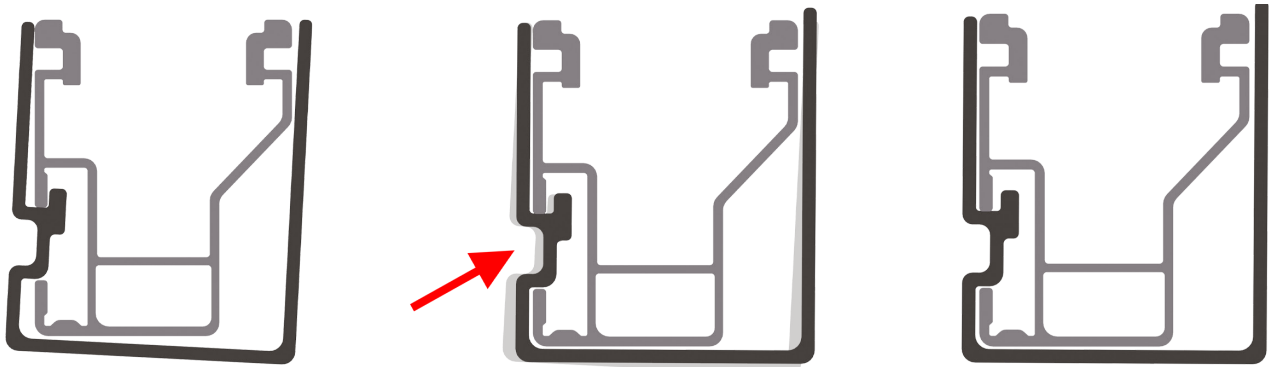

2

! To slide the CrossRail Sleeve on CrossRail, first align the CrossRail Sleeve to the end of the rail.

The CrossRail Sleeve must slide over the end of the rail. Ensure the T-Bolt Key is fully seated within the T-Bolt Channel.

