

## Top Clamping Modules on TPM Rack Installation Supplement

This supplement shows how to attach PV Modules on a Top-of-Pole-Mount (TPM) rack using the top clamp method. It demonstrates the proper use of Mid Clamps and End Clamps along with the associated hardware.

### Correctly Installing Mid and End Clamps

Mid and End clamps must be installed as shown. Failure to do so could lead to personal injury, structural failure and/or damaged components.

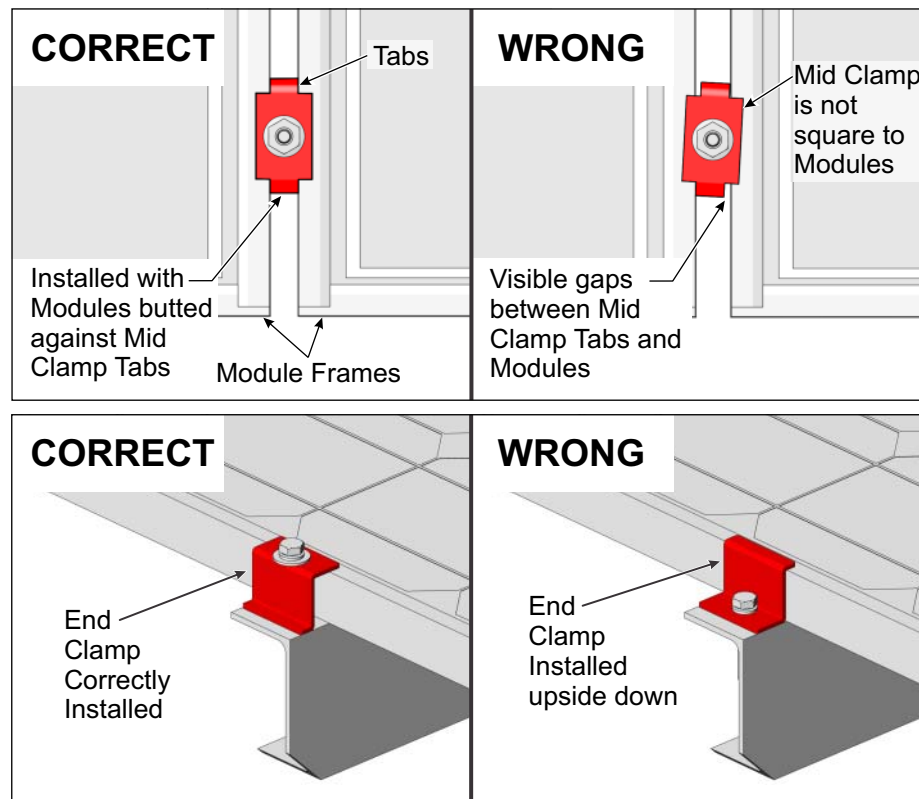

## Installing Mid and End Clamps

Mid Clamps are attached to the Rails using a 5/16" Hex Bolts and hardware. The bolts thread into the factory installed PEM nuts within the Rails.

### Mid Clamps

Mid Clamp tabs must rest between the Modules.

Parts:

- ① 5/16" Hex Bolt (length depends on module thickness)
- ② 5/16" Lock Washer
- ③ 5/16" Flat Washer
- ④ Mid Clamp

**Torque: 14-16 ft.-lbs.**

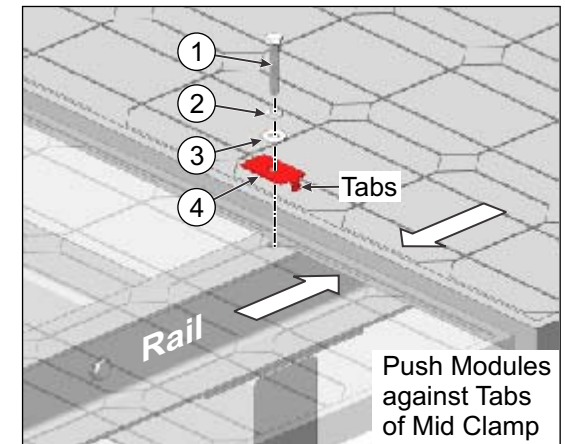

### End Clamps

Make certain that End Clamps are installed as shown and not upside down.

Parts:

- ① 5/16" x Hex Bolt (length depends on module thickness)
- ② 5/16" Lock Washer
- ③ 5/16" Flat Washer
- ④ End Clamp

**Torque: 14-16 ft.-lbs.**

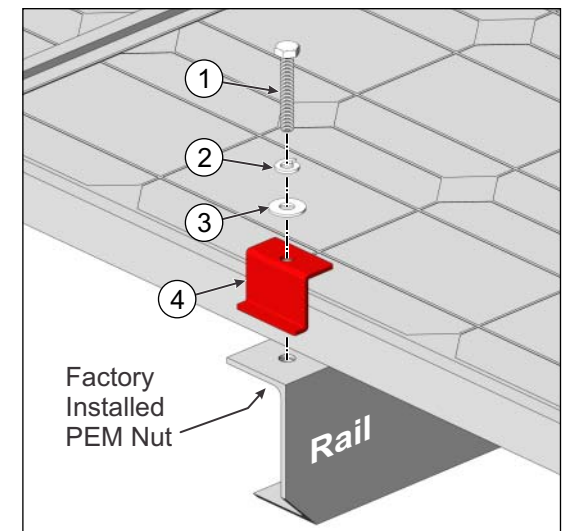



---

2716 Vassar Place NE  
Albuquerque, New Mexico 87107  
USA

Telephone: 800.260.3792  
Fax: 505.889.3548  
Web Site: [www.DPWSolar.com](http://www.DPWSolar.com)  
E-mail: [info@DPWSolar.com](mailto:info@DPWSolar.com)

Preformed Line Products  
(Canada) Limited  
1711 Bishop St. E  
Cambridge, ON N1T 1N5

Telephone: 519.740.6666  
Fax: 519.740.7917  
Web Site: [www.preformed.on.ca](http://www.preformed.on.ca)  
E-mail: [sales@preformed.on.ca](mailto:sales@preformed.on.ca)